

← 4.93 m →

← 1.90 m → ← 2.93 m →

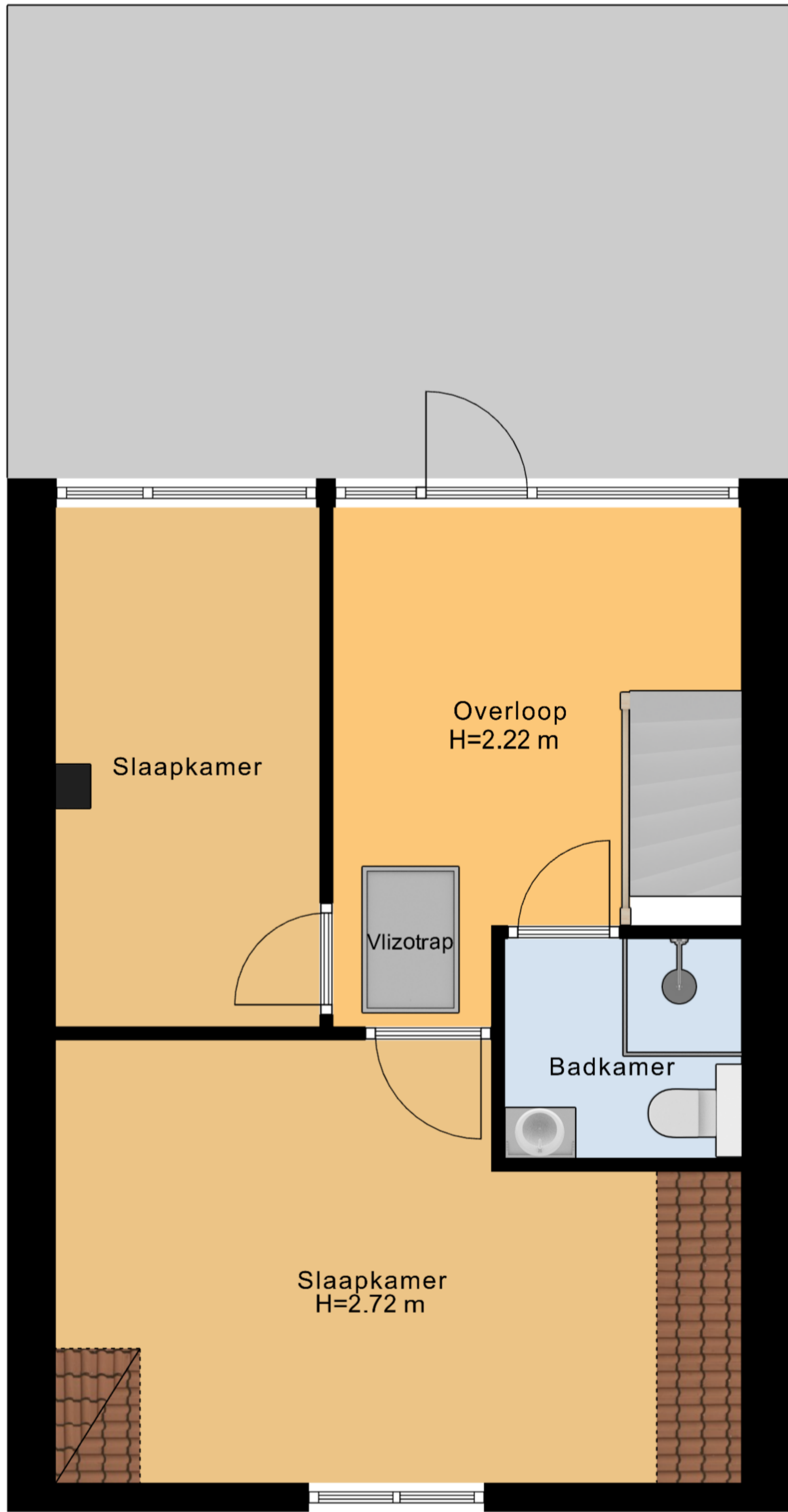

↑ 3.74 m ↓

↑ 7.02 m ↓

↑ 2.22 m ↓

↑ 3.18 m ↓

↑ 3.01 m ↓

↑ 1.57 m ↓

↑ 2.24 m ↓

← 3.72 m →

← 1.14 m → ← 1.70 m →

1e Verdieping